



SHOWER SYSTEMS

Standard Fit Shower System – ProVantage™ Installation Instructions

MATERIALS LIST

- | | | |
|---|--|---|
| <ul style="list-style-type: none"> 1 – Standard Fit Shower Base, 60 inch x 32 inch (specify Left or Right Drain) 27 – 8 inch x 8 inch x 4 inch Glass Blocks 10 – 8 inch x 8 inch x 4 inch EndBlock™ Finishing Units 2 – 8 inch x 8 inch x 4 inch ENCURVE® Finishing Units | <ul style="list-style-type: none"> 1 – ProVantage™ Standard Fit Spacer Pack which includes the following: <ul style="list-style-type: none"> 9 – pcs. 31 inch Horizontal Spacers cut to fit 8 inch x 8 inch x 4 inch EndBlock™ shape 1 – pc. 23 inch Horizontal Spacer cut to fit 8 inch x 8 inch x 4 inch ENCURVE® shape 35 – pcs. 7½ inch Vertical Spacers 2 – pcs. 7½ inch Vertical Spacers cut to fit 8 inch x 8 inch x 4 inch EndBlock™ shape 2 – pcs. 7 inch Vertical Spacers 2 – pkgs. Anchor Packs | <ul style="list-style-type: none"> 1 – Bucket ProVantage™ Glass Block Surface Grout 6 – Tubes Pittsburgh Corning Glass Block Sealant 1 – Chrome Shower Drain 1 – Hinged Shower Door 1 – Shower Door Installation Kit 1 – Bottle Grout Sealer 1 – Installation Instructions |
|---|--|---|

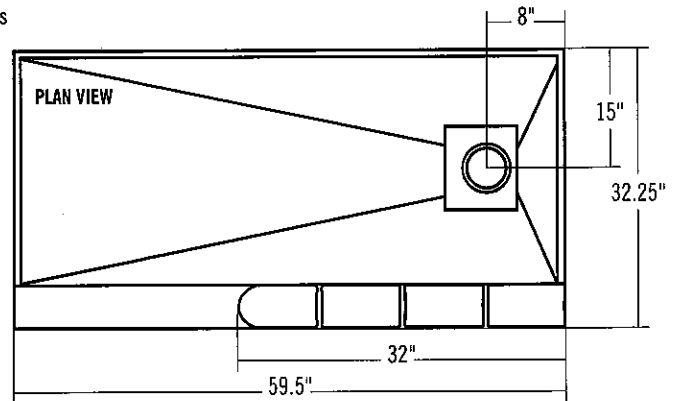
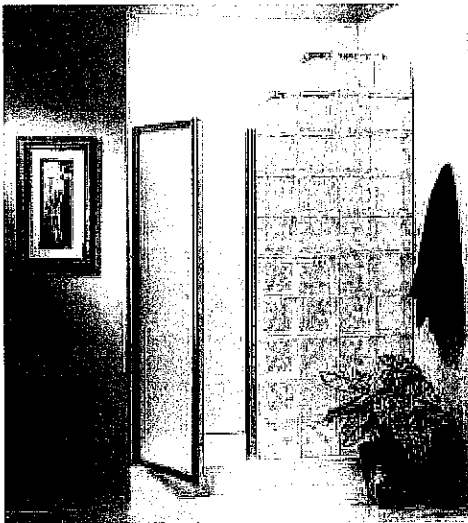

STANDARD FIT SHOWER
(Right Drain)

TOOLS REQUIRED

- » Screw driver, power drill with an ½ inch and a ¾ inch drill bit, ⅜ inch masonry drill bit, long nose pliers, rubber mallet, four-foot level, caulk gun, utility knife, margin trowel, rubber float, bucket, tile/grout sponge, rubber gloves, cheese cloth and safety glasses.
- » To set and install the shower base you will also need a mortar pan, mortar mixer hoe, brick trowel, four 2 inch x 4 inch x 6 inch's, wood shims, galvanized nails, 50 lb. bag of plaster or mortar and a sheet of roofing paper or plastic the size of the shower base.

1. SHOWER BASE INSTALLATION INSTRUCTIONS

For Classic Shower Base, Walk-In Shower Base, Neo Angle Shower Base and Standard Fit Shower Base

Special Notes to Installer

- » All pictures provided with these instructions are typical, and may appear different than the actual items being installed.
- » The installer is solely responsible for determining the requirements necessary for compliance with all codes involving installation of this shower.
- » All published unit dimensions are for reference only. Any critical dimensions required for installation should be taken directly from the shower base being installed.
- » Carefully check the shower base upon receipt. Notify your supplier immediately if any questions or problems are encountered during this process. Do not install the base without first addressing questions, which arise during inspection. Check for:
 - » Unit drain matches to the bathroom drain location.
 - » Surface damage.
 - » Color coordination to other bathroom fixtures.

Continued to next page »

1. SHOWER BASE INSTALLATION INSTRUCTIONS

(Continued)

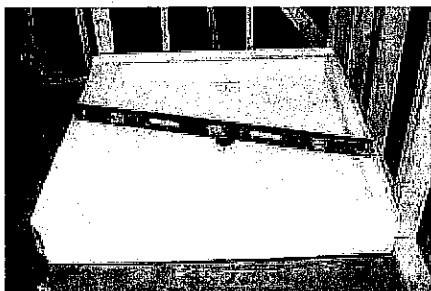

Installation *(Note: Shower base shown in photos may vary from actual style of base being installed.)*

- » Location of drain pipes and shower base drain must be made before the installation of shower base. The drain plug accommodates a 2 inch PVC waste pipe.
- » Insure the floor and stud walls are square and plumb.
- » After leveling base on sub floor (use shims if necessary), draw a line on the studs at the top edge of the shower base flange. This will be the installed height of the shower base.
- » Make certain the drain assembly lines up with drain hole of shower base.

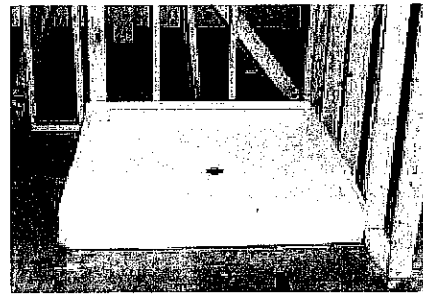
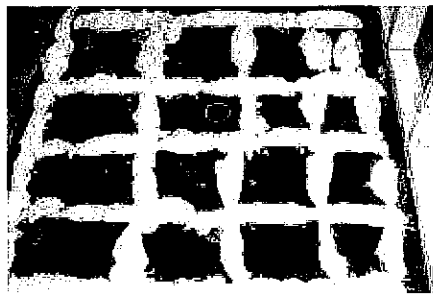
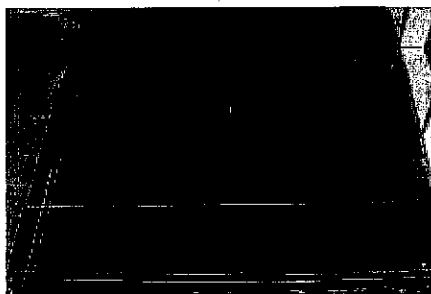

- » Remove shower base and lay down roofing paper or plastic sheet with drain hole mark on it.
- » Mix bedding material (plaster or mortar).
- » Apply bedding material to paper or plastic 2½ inch thick in a 12 inch x 12 inch grid pattern the full length and width of the shower base.
- » Bedding material must not be under the apron (edge).
- » Cut opening in paper at drain and lower shower base into position with drain assembly.
- » It will be necessary to “rock” the shower base until the top of the shower base flange aligns with the lines drawn on the studs.
- » Make certain the apron is contacting the floor along the entire edge of the base. If shims were used re-install them.
- » Insure the base is level in two directions and against the stud framing.
- » Fit drain assembly into shower base. Note: Allow the bedding material to completely harden before applying weight to the bottom of the shower base.

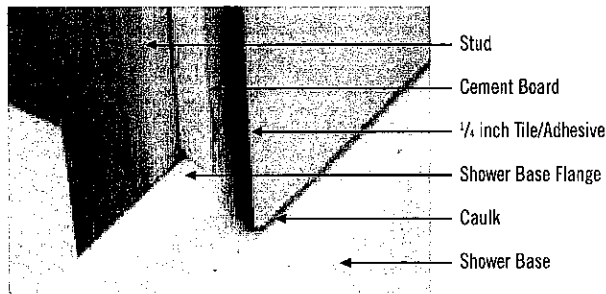
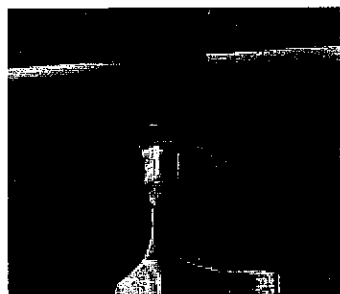
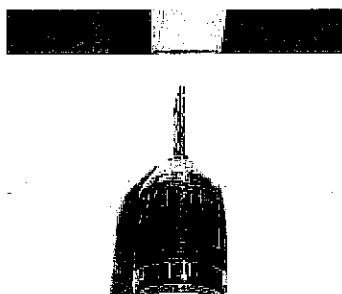

- » Drill 1/8 inch holes through the shower base flange at all stud locations.
- » Secure the base to the studs with 1½ inch roofing nails.
- » Finish installation as shown above.
- » If installing the shower base against an existing wall attach 3/8 inch thick furring strips to walls around the shower base or notch wall to accommodate shower base.

Cleaning Shower Base

- » Use a mild, non-abrasive cleaner specifically formulated for gelcoat and acrylic surfaces. Rinse surface thoroughly.