

Tub/Shower Niche Installation Guide



Read this entire installation guide before beginning your installation.

InnovaShowers Wall Panels are 100% waterproof. We recommend the use of a siliconized sealer like DAP® or SiITex in the seams for added protection. Follow your local building codes for wet environments like shower and tub enclosures. We recommend using the 'Acceptable Substrates' listed to the right to prevent water from getting behind potentially unsealed areas that would cause mold or other damage.

Acceptable Substrates include existing ceramic tile walls, Cement Board®, Schluter Kerdi Board®, GP DensShield®, Johns Manville GoBoard®, HardieBacker®, Fiberock®, moisture resistant greenboard, and equivalent products. Always follow manufacturer's installation instructions to create a waterproof enclosure.

What is included:



Tools and supplies needed:

- Protective eyewear
 - Measuring tape
 - Utility knife
 - Level
 - Hand saw
 - Drill bit & jig saw (for cutting holes)
 - Caulking gun for 10.3 oz. adhesive tubes
 - Adhesive for PVC panels
- (Recommended adhesives: Loctite PowerGrab® Ultimate (white formula), LIQUID NAILS® FUZE*IT®, Titebond Titegrab Ultimate™ and Manus 75-AM HV) (In Canada, use Lepage® No More Nails Wet Grab)**
- Silicone-based sealant



Place a bead of adhesive along the bottom of the opening where the shower niche will be resting. No need to apply adhesive on the sides or top of the opening.

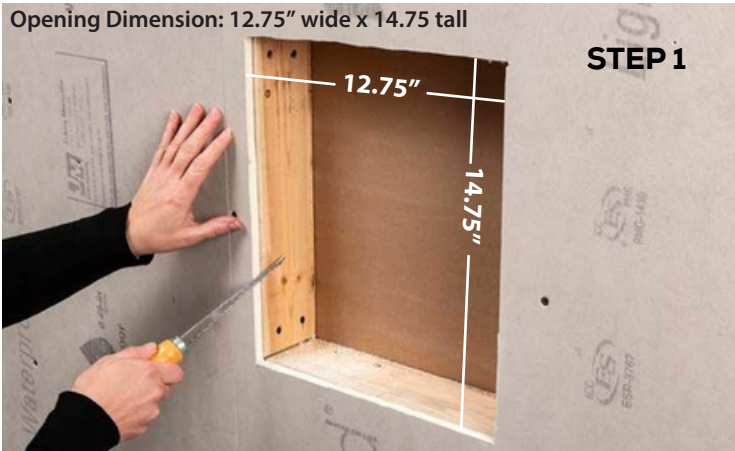

It is best to plan ahead and cut and build your shower niche location prior to installing your wall panels. We suggest the location be away from direct shower spray.



Place a bead of adhesive on back side of the niche flange, approximately a half inch from the outside edge (to leave room for the bead of sealant). Apply the adhesive around the entire perimeter.



Install the shower niche after the wall panel is installed and framed.



Place a small bead of sealant close to the outside edge. Apply it around the entire perimeter.

(continued on next page)



Carefully place the shower niche into the opening.



Once it is in place, wipe off any excessive sealant. As added protection, you can place a small bead of sealant on the top edge only.



www.InnovaShowers.com

877-668-5888